

Help build Future discoveries today

Maine Discovery Museum is a 501(c)3 nonprofit organization and like virtually every other non-profit in Maine, we do not receive any city or state support to operate. **Admissions and programs fees cover only 53% of our expenses;** we rely on donations for the rest, doing all we can to keep our programs financially accessible.

Our programs

At Maine Discovery Museum, we help people of all ages to discover the world around them through creative exploration and science. We cultivate curiosity through interactive and educational programs for people of all ages.

Our programs include:



Annual Membership Options & Perks

Reciprocal Membership \$225

Become a Reciprocal level member at MDM and unlock a world of benefits: free general admission at 350+ ASTC venues & 50% off general admission at 200 ACM venues. Dive into science and tech centers without needing children to enjoy these perks - explore, discover, and join the MDM Reciprocal family today! Note: Exclusions apply, and benefits vary.

Household Membership \$175

Unlimited visits for two adults and all children ages 18 and under living in the same household for one year.

You and Me Membership \$100

Unlimited visits for one adult and one child ages 18 and under living in the same household for one year.

Guest Option Add-on

Add up to TWO (unnamed) guests to any membership for an additional \$45 per year.

Give the Gift of Science And Cultivate Curiosity!

Giving a gift membership is a great way to support the Museum while also sharing your love of science and play with someone who matters to you. It's also a fantastic way to celebrate a birthday, holiday, or just say thank you. All memberships include one year of free admission; discounts on store purchases, special programs, and camps; and early access to events.

Join in-person or online at
mainediscoverymuseum.org/join



www.mainediscoverymuseum.org



MAINE DISCOVERY MUSEUM

map

CULTIVATE curiosity

Hours

Tuesday - Saturday 10am - 5pm
Sunday & Monday Closed
*Open select Sundays for My Day to Play

Admission

\$12 per person
\$10 for seniors/military
Free for Members

Schedule is subject to change; check our website for the latest details

Get in Touch

74 Main Street, Bangor, ME 04401
PH (207) 262-7200

mainediscoverymuseum.org



FLOOR 1

LOBBY

- 1 Penny Crusher
- 2 Gift Shop
- 3 Tickets/Information
- 4 Reptile Room
- 5 Coat Room
- 6 Baseball Diamond

NATURE TRAILS

- 7 Turtle Alley
- 8 Treehouse
- 9 River in Our Backyard
- 10 Beaver Lodge

NATURE TRAILS

Begin your adventure by learning about Maine's amazing animals, waterways, and mountains. Send a boat down the 20-foot river; you control the flow of the water, so get pumping! For a bird's eye view, climb to the top of our two-story treehouse and look down at the beaver lodge.

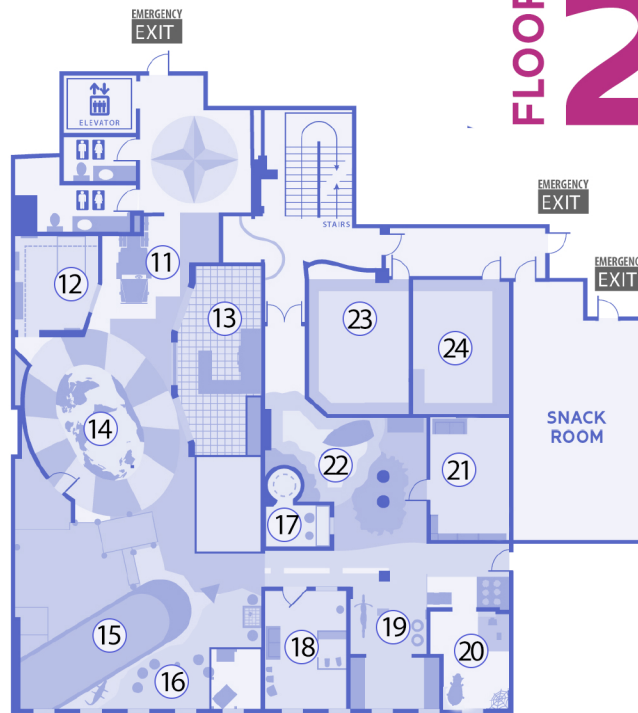

FLOOR 2

TRADEWINDS

- 11 Cole's Truck
- 12 Japan
- 13 Italian Bistro
- 14 World Map
- 15 Cargo Ship
- 16 Brazilian River House

TRADEWINDS

All aboard! You're off to explore foreign ports of trade on our 30-foot cargo ship. After you're done loading cargo, check your compass, put the ship in gear, and steer your way to another part of the world.

BOOKTOWN

- 17 Puppet Theatre
- 18 Goodnight Moon
- 19 Condon's Garage
- 20 Zuckerman's Barn
- 21 Library
- 22 Tidely-Idely
- 23 Program Space
- 24 Robotics Factory

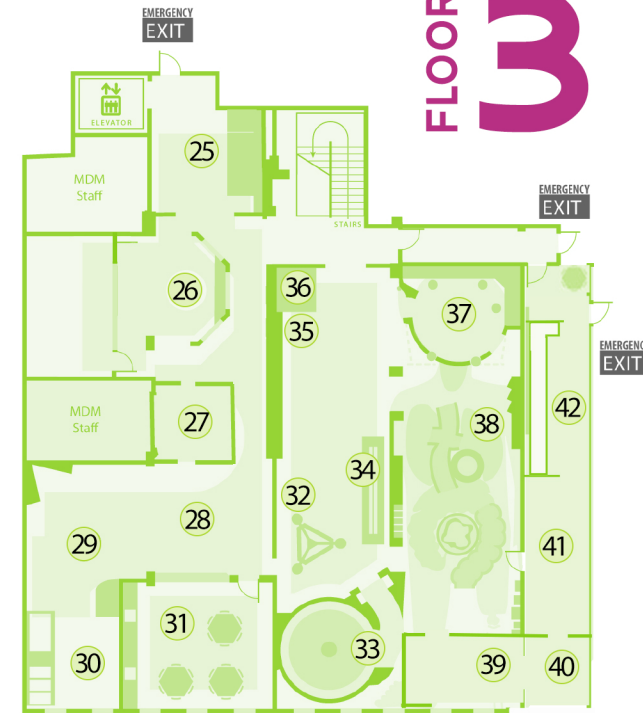

FLOOR 3

- 25 Fire Truck

ARTSCAPE

- 26 The Warming Sea
- 27 Glow
- 28 STEAMscape
- 29 You Build It
- 30 Toddler Area
- 31 STEAM lab

SUN, EARTH, UNIVERSE

- 32 Your Mission to Space, Build a Mars Habitat
- 33 The Engineering Cycle

SUN, EARTH, UNIVERSE

Blast off! In this hands-on exhibition, you'll learn about how scientists study the Earth, Sun, solar system and universe.

- 34 Gravity Tracks
- 35 Air Time
- 36 Invisible Science

BODY JOURNEY

- 37 Brain Games
- 38 Heart
- 39 Doctors Office
- 40 PetVet

DINO DIG

- 41 Toddler Exploration
- 42 Dino Dig Pit